

SIGNALGUARD « TLO »

A SAFETY GUARDRAIL EASILY CONFIGURED ACCORDING TO YOUR NEEDS



DELIMIT

GUIDE

OPTIMIZE

A SAFETY GUARDRAIL EASILY CONFIGURED ACCORDING TO YOUR NEEDS

Signal Services has been working for 30 years to find solutions that make life easier for its customers at a lower cost.

The **Sign Guard** is the perfect demonstration of this.

Designed and prototyped here in St-Mathieu-de-Laprairie by our team of engineers, the Signal Guard has grown over the past 3 years. It has evolved and has been tested in several configurations across Quebec. As a result of this work, in 2021, **the Signal Guard was certified NCHRP350 TL1 and TL2*** and applicable in «TL0» to many other applications.

Do you want to know more? Follow the guide!

LIGHT. OPTIMAL. MODULAR.



Signal Guard installation projects in Montreal

* on Signal Guard configuration without fences.



DELIMIT

Our «TL0» guardrail is used to:

- Delineate a work area, storage area, parking,
- Separating residential areas and courtyards,
- Protect from vandalism when installed with a fence.

Its modularity allows use for many solutions - the choice is yours!

GUIDE

THE SIGNAL GUARD GUIDES MOTORISTS.

Drivers often receive confusing and even contradictory messages in work areas. Unfamiliar detours, narrowing lanes, close cross-traffic create stressful situations that may cause disorientation. Unfortunate contacts may result with other vehicles, or the more vulnerable pedestrians, cyclists and workers.

Day or night, the **Signal Guard** visually **shows the path to follow through** a work area, a parking lot, an industrial plot... and gives the driver an actual physical corridor. High intensity reflectors may also be added for the clearest guidance.

THE SIGNAL GUARD GUIDES PEDESTRIANS.

By creating **specific corridors**, pedestrians are assured safe passage. Access to crossings, shops and homes can be separated from work areas and traffic lanes. The **Signal Guard also minimizes the risk of falls** for people with disabilities, thanks to its flat base and continuous lines.



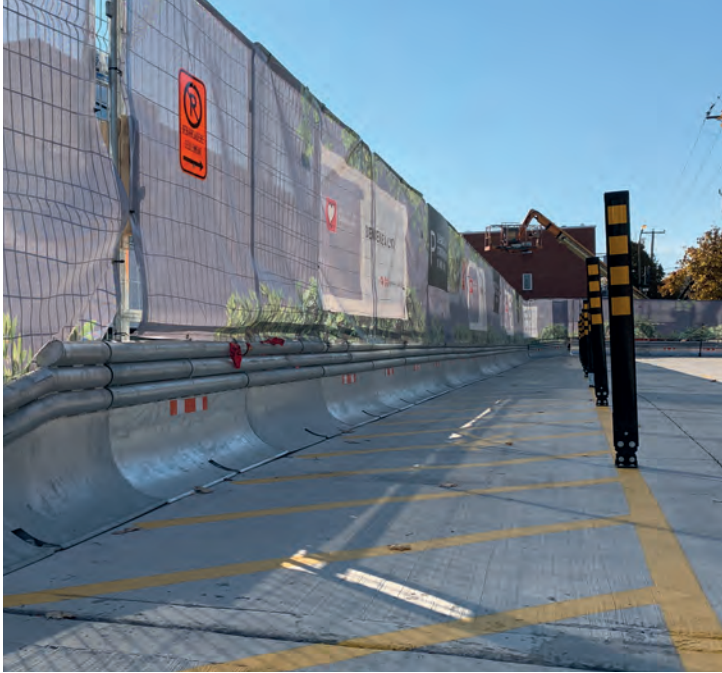

OPTIMIZE

Its design makes the **Signal Guard** the most practical and easy to use guardrail whatever the spaces.

Facilitated traffic flow, separated pedestrian corridors and protected work areas can be achieved. The **compact and clean Signal Guard** makes it possible.

Your budget will be reduced. Their lightness and size reduce transport and installation costs in comparison to concrete barriers: fewer trucks by installation length and smaller work teams for mobilizing, reconfiguring and demobilizing.

PERSONALIZATION POSSIBILITIES FOR INFORMATIONAL, ADVERTISING OR OTHER PURPOSES.

We can affix your logo, phone number or company name to positively identify your material.

Add reflective strips to increase nighttime visibility.





MOBILIZATION, DEMOBILIZATION & ADJUSTMENTS

The **Signal Guard** is the lightest temporary guardrail system to transport and the easiest to install and uninstall. The impact on traffic during installation or removal is therefore minimized.

During mobilization and demobilization, fewer trips are required to transport them to the site thanks to their lightness and small footprint. With a flatbed trailer you can transport more than a hundred units, or up to sixty in a 16 feet cube truck.

Once there, installation is done by hand, with no need for special tools. The **Signal Guard** guardrails are linked one to the next and locked securely using tubes. Anchoring to the ground at the start and end is enough to give it its TL1 and TL2* rating. Our teams are trained and can install your small project in a few hours or more for your larger projects.

* Non mandatory in « TL0 »

MAINTENANCE & STORAGE



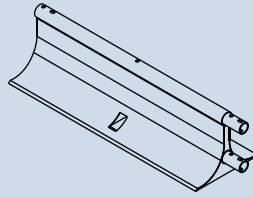

Signal Guard is sturdy, made of steel and rarely destroyed. For on-site maintenance, the guardrails may need repositioning after an impact. When returning from a job, inspection is recommended before re-use. Dent removal may be necessary after scrapes with a vehicle or construction equipment.

Storage is done easily and stacking saves space. Their light weight allows manual handling.

SIGNAL GUARD TO COMPARE



SPECIFICATIONS	SIGNAL GUARD	NEW-JERSEY BARRIER
DIMENSIONS SECTION LENGTH WITH INSERTION TUBE	1500 mm x 500 mm x 425 mm 1630mm	4000 mm x 615 mm x 823 mm
WEIGHT	59 kg	2360 kg
MATERIAL	Galvanized steel	Concrete
ANCHORING	250 mm anchor rods at the beginning and end	Non required

+ AVANTAGES & - DISADVANTAGES	SIGNAL GUARD	NEW-JERSEY BARRIER
ENCLOSURE / FENCE	<p>+ Yes 3 dimensions - 1070 mm (H) x 3000 mm (L) - 1580 mm (H) x 3000 mm (L) - 2000 mm (H) x 3000 mm (L)</p>	<p>+ Yes - 1580 mm (H) x 1870 mm (L)</p>
MOBILIZATION	<p>+ Installed manually</p> 	<p>- Specialized equipment</p> 
STORAGE	<p>+ </p>	<p>- </p>
REFLECTORS	<p>+ </p> <p>Hight intensity reflective stripes to increase visibility applied directly on the guardrail</p>	

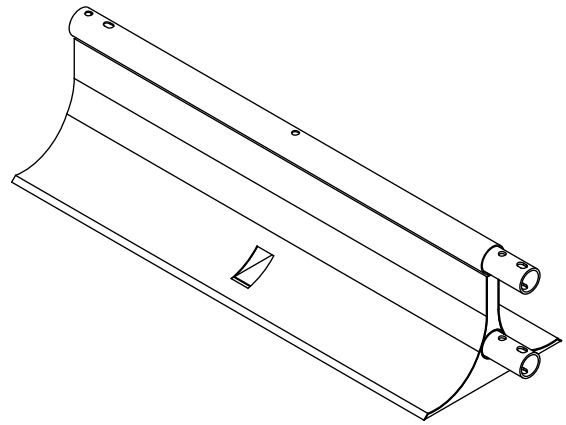
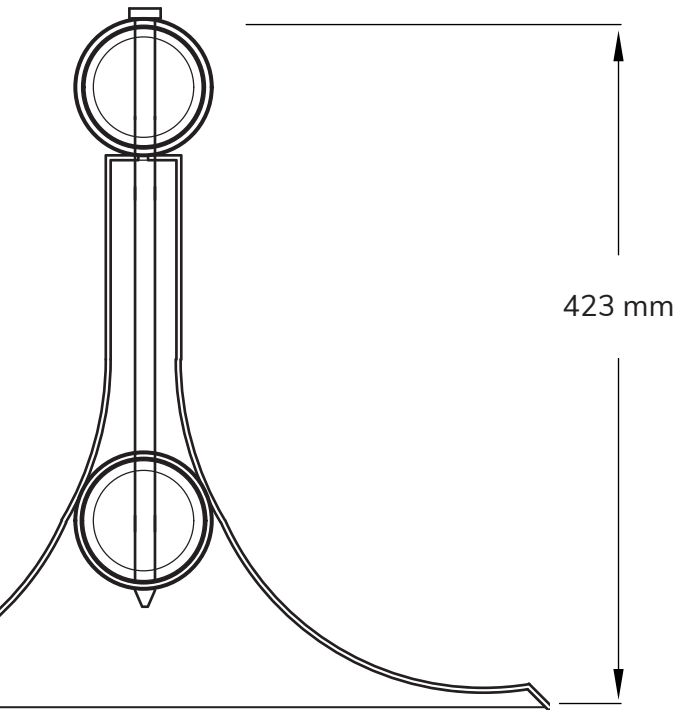
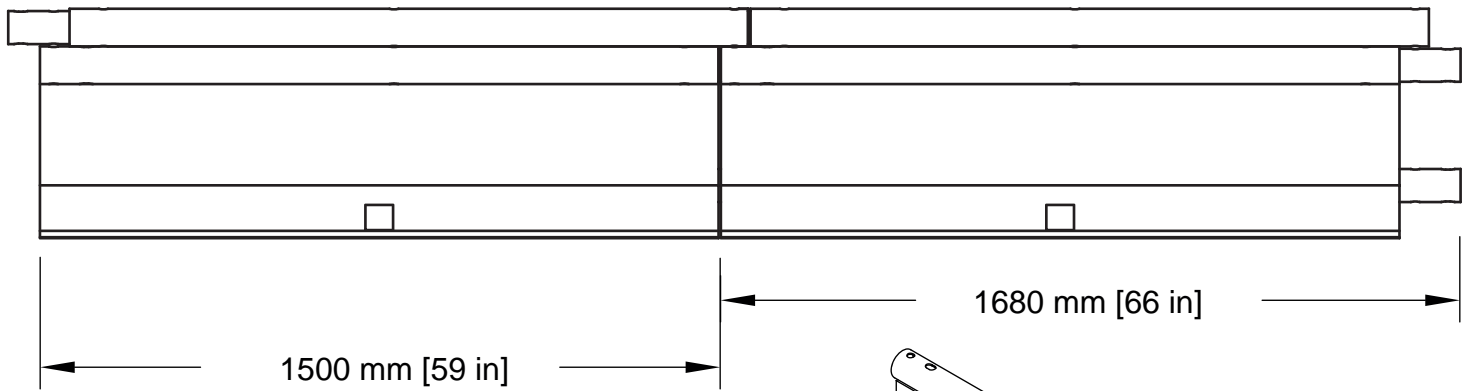

DIMENSIONS

	Dimensions (mm)	Weight (kg)
MAIN GUARDRAIL	1,630 LO X 500 LA X 423 H	59
LATCH TUBE	Ø83 X 1640	13
ANCHORING	Ø16 X 254	0.5
45° CORNER UNIT (LEFT/RIGHT)	515 LO X 565 LA X 423 H	22
CORNER FENCE	1,580 H X 310 LA	7
STARTING UNIT (MALE)	1,630 LO X 500 LA X 423 H	30
ENDING UNIT (FEMALE)	1,630 LO X 500 LA X 423 H	30

COMPATIBLE FENCES

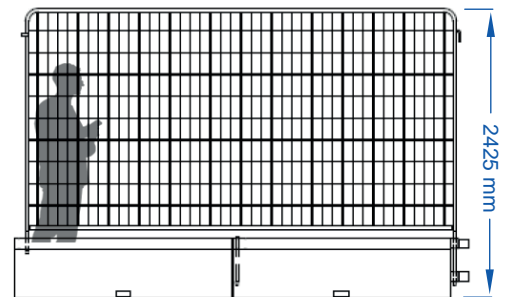
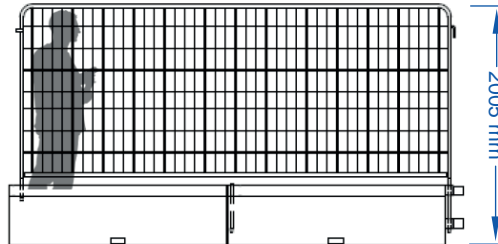
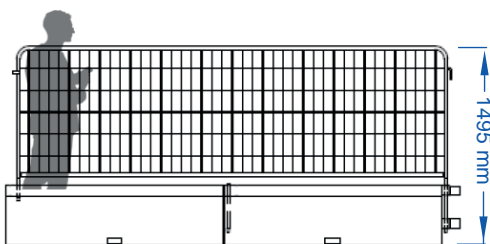

AB1022 • GALVANIZED
10' x 42" (3 m x 1.06 m)

AB1027 • GALVANIZED
10' x 63" (3 m x 1.6 m)

AB1025 • GALVANIZED
10' x 6' 6" (3 m x 2 m)

* assembled height in « TLO » Signal Guard configuration.



MANUFACTURING • SALE • RENTAL
ROAD SAFETY AND SIGNALING EQUIPMENT



SIGNAL SERVICES

700, Montée Monette, Saint-Mathieu-de-Laprairie - Québec, Canada J0L 2H0

✉ info@signal.ca

☎ 450-444-0006

📠 450-444-0045